

GLOBE SYSTEMS

# 2globes -DECT DONGLE SPECLIST

---

2024

2globes.com

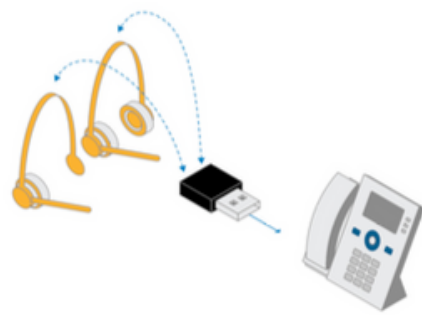
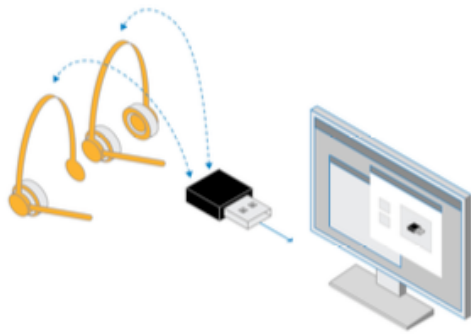

# WHEN RELIABLE AND FLEXIBLE CONNECTION IS IMPORTANT

## DECT DONGLE

Many types of office work can be performed anywhere, as long as you have a reliable and flexible communication solution that allows you to seamlessly connect with colleagues, customers, suppliers, etc. - whether you are in the office, at home or on the move. The 2globes3741 DECT dongle seamlessly connects various types of communication devices - it can function both as a fixed DECT base, providing connection between a 2globes DECT headset and, for example, a PC or a desktop phone, and a portable 2globes DECT handset, providing connection between a desktop phone and 2globes VoIP infrastructure. The dongle is a USB type A dongle with a slide switch, which makes it possible to quickly switch between fixed and portable mode.

### BUSER SCENARIOS

In addition to offering an end-to-end communication solution, the 2globes3741 DECT dongle offers three additional user options: DECT dongle on PC, DECT dongle on wired phone (fixed part) and DECT dongle on wired phone (portable part) - each providing a different system depending on the user scenario.



### DECT DONGLE ON PC

You can connect the DECT dongle to a laptop/PC, and it functions as a base with call control for a DECT headset. Registration of the headset is done by putting both the dongle and the headset in registration mode. You can select the active audio device (headset) via the Windows / MacOS PC. All calls are created from the PC using, for example, MS Teams, and you can mute the microphone on the PC or on the headset itself.

### DECT DONGLE ON DESK PHONE (FIXED PART)

You can connect the DECT dongle to a desk phone (with USB port), and it functions as a base for a DECT headset. Registration of the headset is done by putting both the dongle and the headset in registration mode. You can select the active audio device (headset) on the desktop phone, which requires desktop phone support - we provide a USB HID interface. All calls are created from the desktop phone, and you can mute the microphone on the headset itself.

### DECT DONGLE ON DESK PHONE (PORTABLE PART)

You can connect the DECT dongle to a desk phone (with USB port), and it functions as a handset, providing connection between the desktop phone and 2globes VoIP infrastructure. This is very useful for workplaces with hot desking, where it doesn't matter which desk or desk phone you use - you can always be reached, as your phone number is stored in the dongle.

**"Reshape your working life with 2globes - where reliable and flexible communication paves the way for unparalleled mobility!"**

# Technical specifications

FEATURES	SPECIFICATIONS
<b>Dimensions</b>	35mm (L) x 19mm (W)
<b>DECT</b>	1880 – 1895 MHz (Taiwan)
	1880 – 1900 MHz (EMEA)
	1910 – 1920 MHz (Brazil & Uruguay)
	1910 – 1930 MHz (LATAM, Argentina, Chile)
	1920 – 1930 MHz (USA, Canada)
<b>Audio</b>	G726, BV16, G722, BV32, CELT 128 kbit/s
<b>LED Indicator</b>	Three LEDs
<b>Hardware Features</b>	Button for registration and reset
	Slider switch for switching between FP and PP mode
<b>Call Features</b>	Call waiting, hold/retrieve
<b>Headset Supported</b>	RTX7251, RTX7252, RTX7254
<b>Conference Support</b>	Up to 4 users
<b>Customer Logo</b>	Silk screen
<b>Call Indication LED on Dongle</b>	Yes
<b>DECT Connection Status LED on Dongle</b>	Yes
<b>Configurable</b>	Yes, via PC Tool
<b>Firmware Update Support</b>	Yes, via PC Tool
<b>USB Connector</b>	TypeA
<b>PC Windows Support</b>	Yes
<b>MacOS Support</b>	Yes
<b>DECT Audio Support</b>	Wide-band audio: CELT, G.722, BV32
	Narrow-band audio: G.726, BV16
<b>Call Client Support</b>	Microsoft Teams: Yes
	Microsoft Skype for Business: Yes
<b>Adaptive Power Control (DECT)</b>	Yes